

# PML

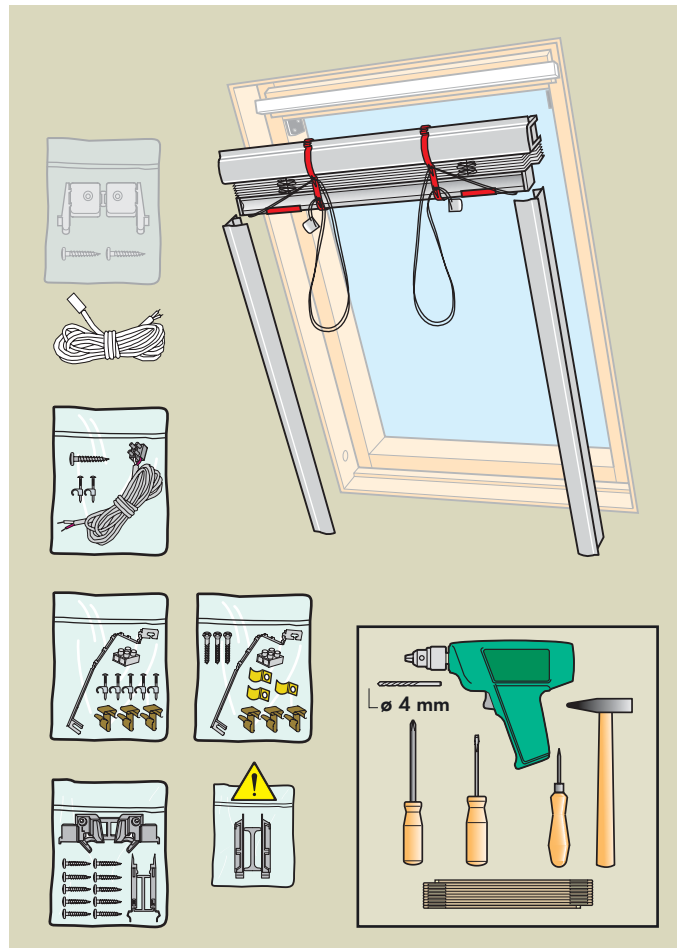

1

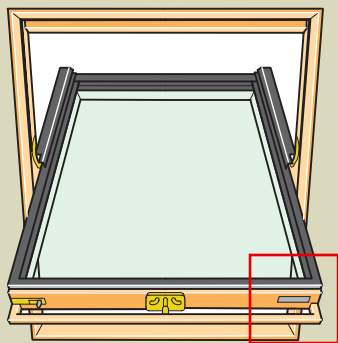

2

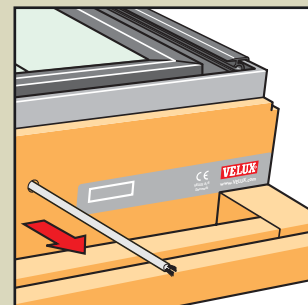
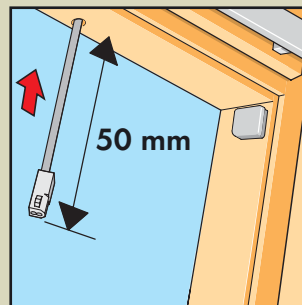
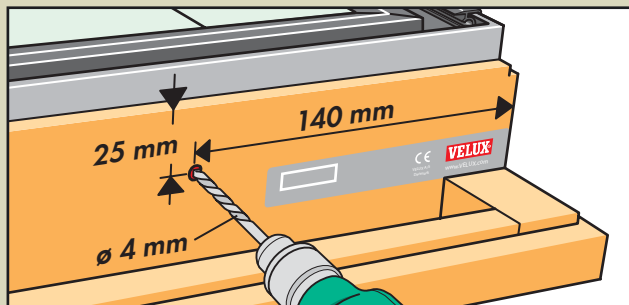
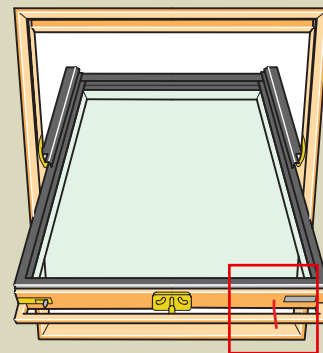

3

4

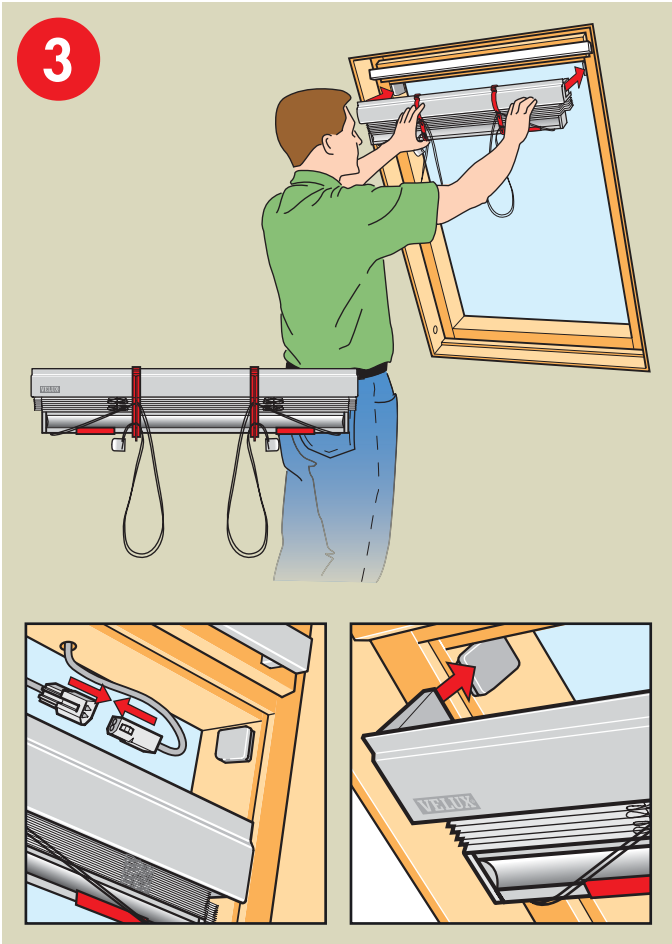

5

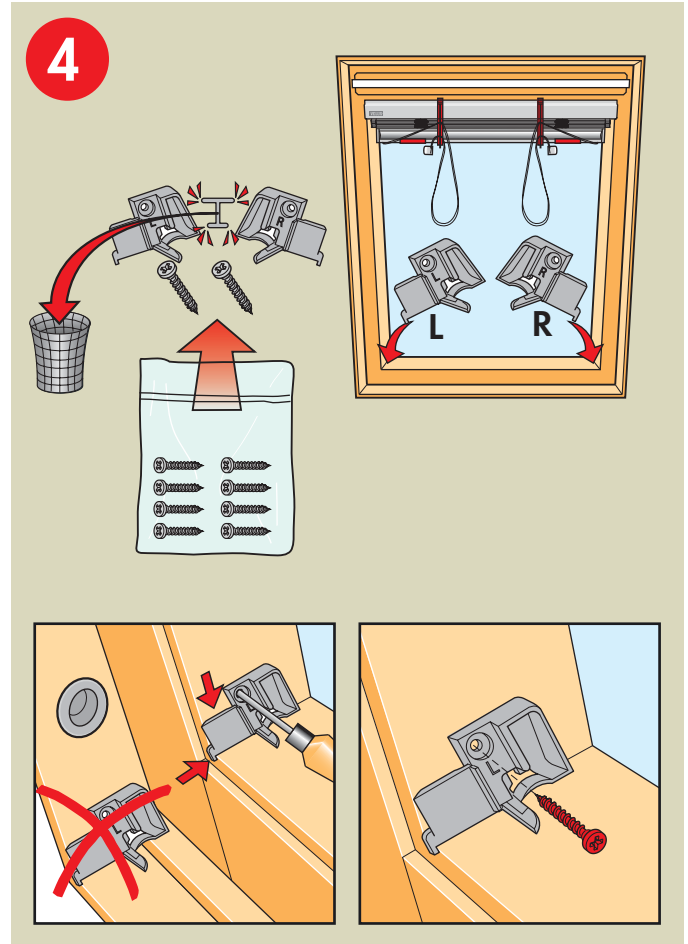

6

5

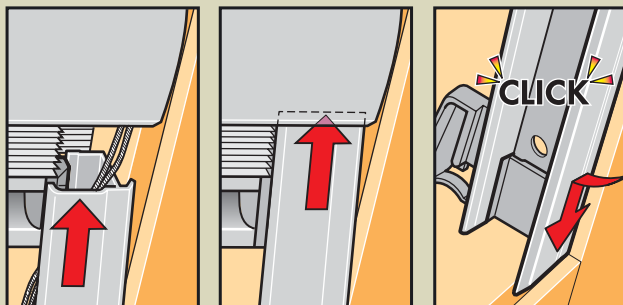
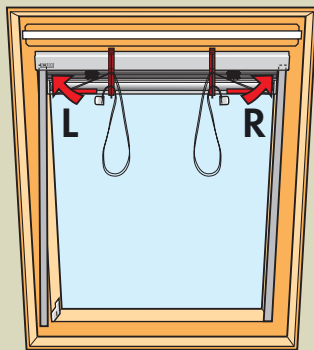
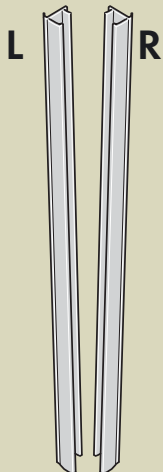

A:	VELUX Österreich GmbH ☎ 02245/32 3 50	J:	VELUX-Japan Ltd. ☎ 03(3478)81 41
AUS:	VELUX Australia Pty. Ltd. ☎ (02) 9550 3288	LT:	VELUX Lietuva, UAB ☎ (85) 270 91 01
B:	VELUX Belgium ☎ (010) 42.09.09	LV:	VELUX Latvia SIA ☎ 7 27 77 33
BG:	VELUX Bulgaria EOOD ☎ 02/955 99 30	N:	VELUX Norge AS ☎ 22 51 06 00
BiH:	VELUX Bosna i Hercegovina d.o.o. ☎ 033/626 493, 626 494	NL:	VELUX Nederland B.V. ☎ 030 - 6 629 629
BY:	VELUX Roof Windows ☎ (017) 217 7385	NZ:	VELUX New Zealand Ltd. ☎ 09-6344 126
CDN:	VELUX Canada Inc. ☎ 1 800 88-VELUX (888-3589)	P:	VELUX A/S - Sucursal em Portugal ☎ 21 880 00 60
CH:	VELUX Schweiz AG ☎ 062/289 44 44	PL:	VELUX-POLSKA Sp. z o.o. ☎ (022) 33 77 000 / 33 77 070
CHN:	VELUX [CHINA] CO. LTD. ☎ 0316-607 27 27	RA:	VELUX Argentina S.A. ☎ 0 114 711 5666
CZ:	VELUX Česká republika, s.r.o. ☎ 531 015 511	RCH:	VELUX Chile Limitada ☎ 2-231 18 24
D:	VELUX Deutschland GmbH ☎ 0180-333 33 99	RO:	VELUX România S.R.L. ☎ 0-8008-83589
DK:	VELUX Danmark A/S ☎ 45 16 45 16	RUS:	VELUX Rossia ZAO ☎ (095) 737 75 20
E:	VELUX Spain, S.A. ☎ 91 509 71 00	S:	VELUX Svenska AB ☎ 042/144450
EST:	VELUX Eestli OÜ ☎ 601 1046	SK:	VELUX Slovensko, s.r.o. ☎ (02) 60 20 15 00
F:	VELUX France ☎ 0821 02 15 15 0,119€ TTC/min	SLO:	VELUX Slovenija d.o.o. ☎ 01 564 14 84
FIN:	VELUX Suomi Oy ☎ 09-887 0520	TR:	VELUX Çatı PencereLeri Ticaret Limited Øirketi ☎ 0 216 302 54 10
GB:	VELUX Company Ltd. ☎ 0870 380 9593	UA:	VELUX Ukraina TOV ☎ (044) 490 5703
H:	VELUX Magyarország Kft. ☎ (06/1) 436-0530	USA:	VELUX America Inc. ☎ 1-800-88-VELUX
HR:	VELUX Hrvatska d.o.o. ☎ 01/6221 212	YU:	VELUX Jugoslavija d.o.o. ☎ 011 3670 468
I:	VELUX Italia s.p.a. ☎ 045/6173666		
IRL:	VELUX Company Ltd. ☎ 01 816 1616		

[www.VELUX.com](http://www.VELUX.com)

Installation instructions for PML Order no. VAS 451483-0805

6

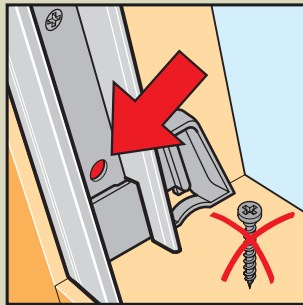
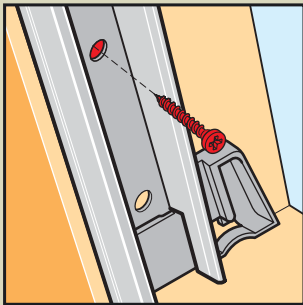
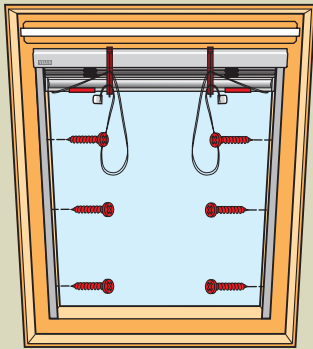
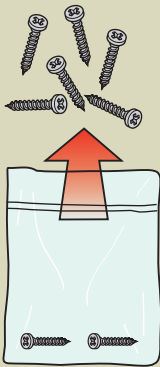

8

7

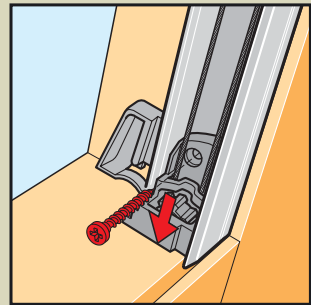
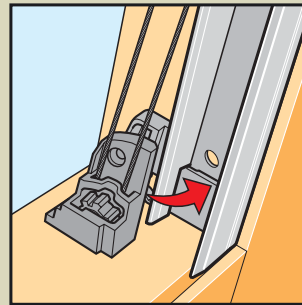
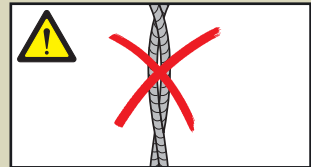
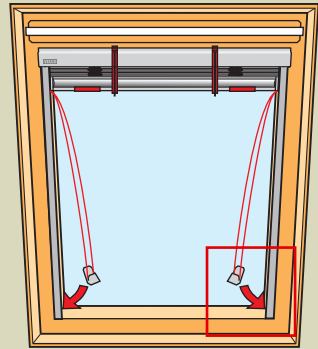
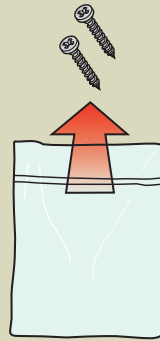

9

8

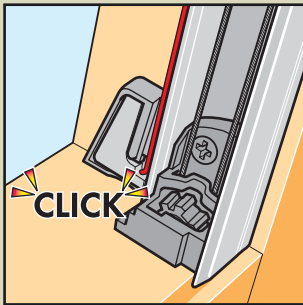
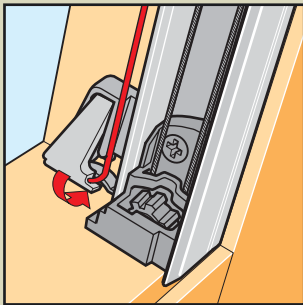
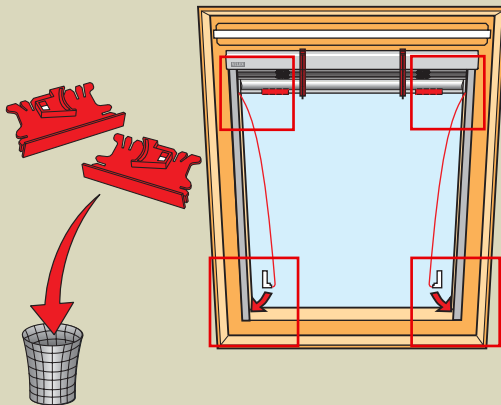

9

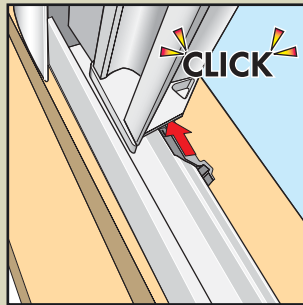
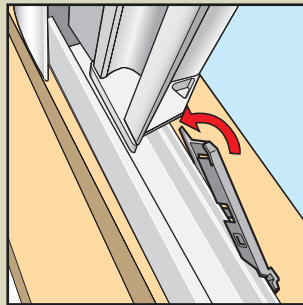
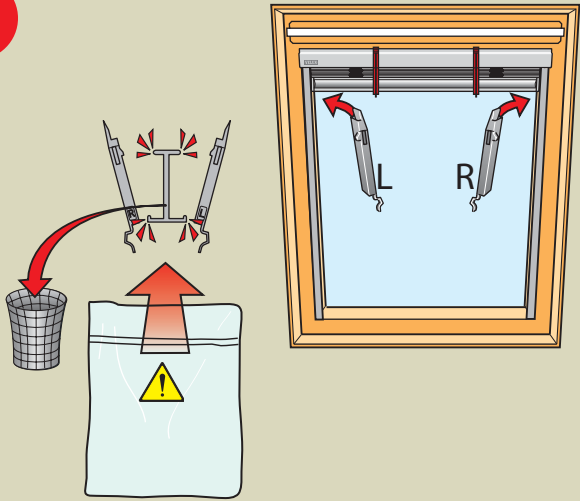

10

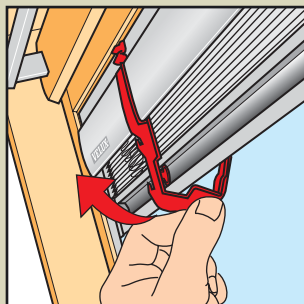
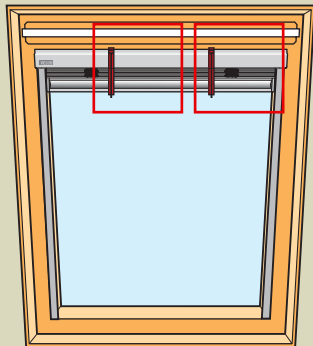
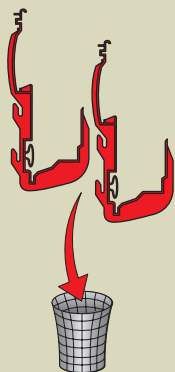

12

11

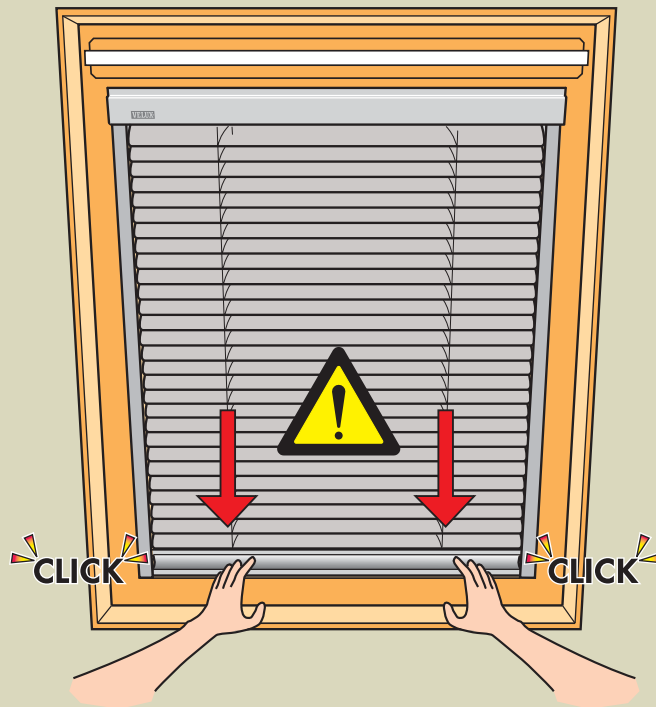

13

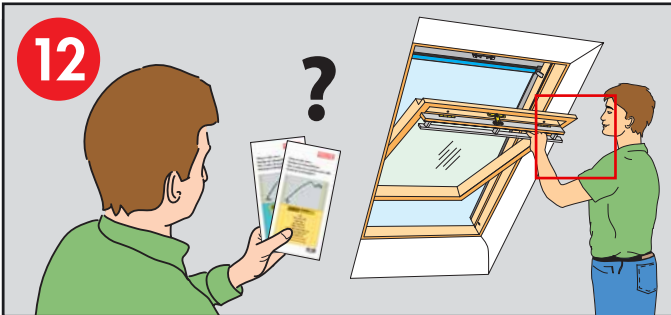

12



**B04**  
**C01 • C02 • C04**  
**F04 • F06**  
**M04 • M06 • M08 • M10 • M12**  
**P25 • P04 • P06 • P08 • P10**  
**S01 • S06 • S08 • S10**  
**U04 • U08 • U10**  
**X99**

**064**  
**101 • 102 • 104**  
**204 • 206**  
**325 • 304 • 306**  
**308 • 310 • 312**  
**425 • 404 • 406 • 408 • 410**  
**601 • 606 • 608 • 610**  
**804 • 808 • 810**  
**1 • 2 • 3 • 4 • 5 • 6 • 7 • 8 • 9**  
**10 • 11 • 13 • 14 • 31 • 999**

