

## General information

It is important that you follow the assembly- and operating instructions carefully. We do not accept any responsibility if the assembly or operating instructions have not been followed or are followed incorrectly.

## Assembly

### 1. Marking Out

Mark out the fixing position of the mounting brackets on the frame or on the ceiling, as shown in the drawing. Fix two mounting brackets each a maximum of 40 mm from either end of the top rail, plus additional brackets, as necessary for every 500mm of width.

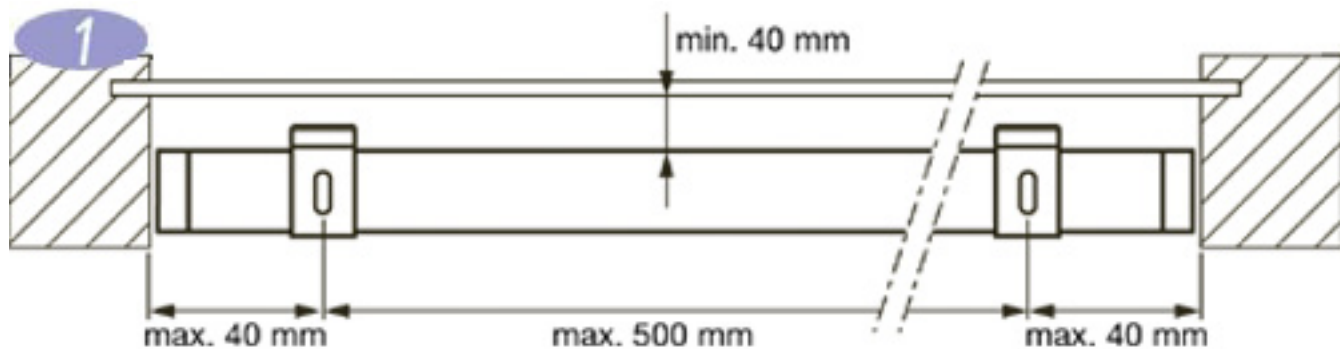

Make sure that the fixing surface is sufficiently strong to take the weight of the blind. Choose the position of the mounting brackets so that the product will not be obstructed during operation by projecting parts, such as window or door handles, levers etc. The Roman blind must be fitted at a minimum of 40 mm away from the glass or the wall to guarantee that it will work unhindered.

### 2. Fixing mounting brackets

Always use the mounting brackets supplied. Both standard universal top/face fit brackets (2a/b), and special top fix only brackets (2c) are supplied. Fix brackets into place, using the screws supplied, options as shown in the pictures (2a/b/c).



a. top/face fit brackets



b. top/face fit brackets



c. special brackets

### 3a. Fastening top rail

Wall/ceiling bracket: Locate the rail in a slightly tilted position and slide this over the metal edge of the bracket (3a). Then press the rail back and slide the swivel lever back to lock the rail in place (3b).



3b. Special top fix only bracket: Open the lever and place the rail against the bracket (3c). Then press the lever back to lock the rail in place (3d).

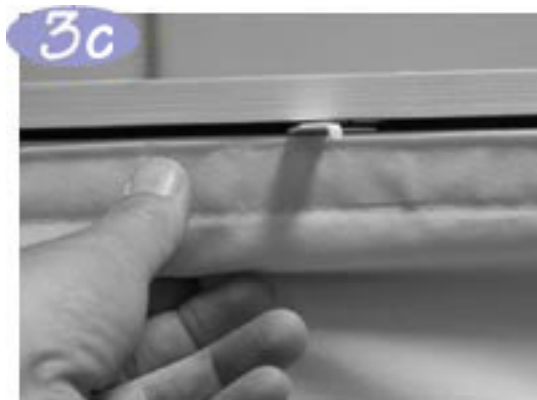

## Operation

4. Using the control chain, the Roman blind can be raised and lowered

N.B: when you initially pull up the blind, you will have to manually help it drop into pleats. After the blind has been raised and lowered a few times, the blind will automatically drop into pleats more easily.

## Assembly Options

Depending on use, there are a number of possible assembly options:

### 5a. Side guide "in Recess" with sill bracket

The guide wires (already fitted in the top rail) must be fitted perpendicular to the top rail. Adjust the position and tighten the locking ring onto the cable so that the cable is tight. Mount the sill bracket in position and slide the locking ring under the sill bracket.



Side guide "in Recess"

### 5b. Side guide "On Face" with face fix angle bracket

The guide wires (already fitted in the top rail) must be fitted perpendicular to the top rail. Adjust the position and tighten the locking ring onto the cable so that the cable is tight. Mount the bracket in position and slide the locking ring under the bracket.



Side guide "On Face"

### 6. Assembly onto a plastic or aluminium frame using a Tilt and Turn clamp bracket

Unscrew the clamp bracket with the rail support using the allen key supplied so that the locks can be slid over the top of the synthetic frame. Check that the position chosen corresponds to assembly step 1. Tighten the locking screw again (6a). Repeat this with the other top brackets. Fasten the top rail as described in assembly step 3c. Unscrew the bottom clamp brackets (round model) with the allen key, so that the support can be slid over the bottom edge of the frame.



a. assembly top brackets

Position the bottom brackets so that they are 40mm from the edge of the blinds and tighten the allen screw (6b). Position the guide wire (already fitted in the top rail) into the opening of the bottom bracket. Lock the guide wire into position by tightening the allen screw (6c). Check to see that the blind slides correctly up and down the guide wire. After this the guide wire can be snipped off to fit.



b. assembly bottom brackets

### 7. Assembly with electrical control

From the top rail a twin cable comes from the 24-Volt integrated motor and must be connected via your selected control unit to a 24-Volt power supply.



c. locking guide wire

## Demounting

By pulling the swivel lever towards you (using a small flat bladed screwdriver ); you can easily remove the Roman blind.

## Cleaning

The top rail can be cleaned using a gentle cleaning agent.

### 8. Cleaning fabric

To clean the fabric, this must first be removed from the top rail as follows: Unhook the cords from the bottom rings and pull these up out of the rings or loops (8a). Then take (if applicable) the stiffeners and bottom slat out of the blind (8b). At the top pull the fabric off the Velcro fastener on the top rail (8c).

Follow the instructions on the washing instruction label on the top of the blind. After cleaning, fasten the blind on to the top rail again, attach the cords by threading the hooks through the rings or loops and hooking on again to the bottom rings with the opening of the hooks to the inside (8d).

### Cleaning advice

The blind fabric must be taken off the top rail.

To prevent serious soiling, you can regularly dust the blind with a feather duster or use a vacuum cleaner on low power. If there are stains, we would advise that you remove these as quickly as possible with a soft sponge and luke warm water (max. 30°C) and if needed, a non-synthetic washing powder. Washing instructions are attached to the top of the blind for cleaning the fabric.

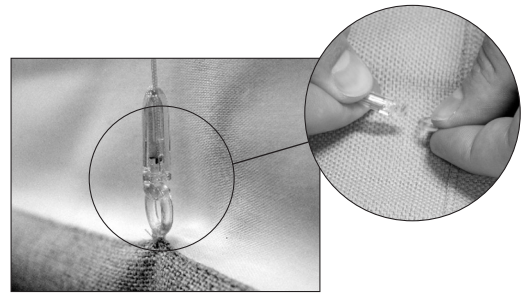

a. unhook cords

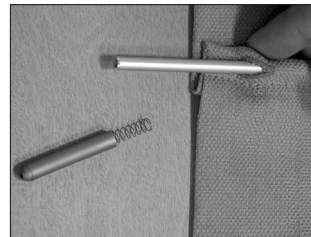

b. remove stiffeners



c. remove fabric

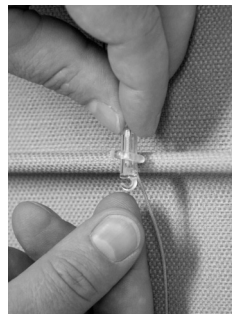

d. threading the cords

## **Shrinking**

Fabrics can sometimes shrink due to the effects of moisture and changes in temperature.

Natural fabrics like cotton, linen, silk, viscose and mixtures thereof, are the most susceptible to this, but polyester fabrics can also shrink. Our norms comply with the textile standard.

- Polyester fabrics: maximum 1.5%
- Natural or compound fabrics: maximum 3%

Despite careful checking this may result in minor variations in dimensions on delivery or even thereafter. The washing instructions must be adhered to precisely. Washing in hot water or brushing can seriously affect the dimensions of your blind.

## **Manufacturing Spots**

Small purple spots may appear on the fabric of your Roman blind. These are there so that the fabric can be manufactured correctly. These spots will disappear within 14 days.

## **Type of Cloth**

The fabrics in this collection often have a natural composition and character. In certain fabrics bulges and irregularities can occur that are part of the nature of the particular cloth.

## **Liability**

The manufacturer accepts no liability if the assembly or operating instructions have not been followed. We accept no responsibility for the results of cleaning.

Changes or product improvements are reserved.